



PANEL MOUNT SERIES

System Component DC Power Supplies in 12 and 24VDC Output

The ICT Panel Mount Series switching power supplies are intended for use as system components, and are ideal for powering 12 and 24 volt communications equipment, industrial radios, cameras or monitoring instruments. The vented steel chassis construction ensures superior durability, while threaded mounting holes facilitate easy and reliable installation into equipment enclosures. Terminal blocks are used for both input and output connections for maximum strength. Standard to all Panel Mount Series is a 5V power good signal. Battery backup terminals, forced air cooling, and open frame options are available depending on the model.



Performance and Flexibility

ICT Panel Mount Series utilize our field proven quiet, high efficiency switchmode designs to provide pure, clean DC power. Current limiting is built in, and an internal fuse protects the power supply and the loads. Extra input and output filtering ensure that interference and noise are virtually eliminated.

Isolated outputs make the Panel Mount Series compatible with positive or negative ground equipment, and series or parallel operation is possible.

Reliability

The ICT Panel Mount Series is designed for enclosure mounting, built with high efficiency electronics and only the highest quality components. Terminal block connectors are used for maximum wire holding strength.

Certification

The ICT Panel Mount Series are CSA 22.2 No 107.1, UL 1012 approved (except ICT22012-3APB).

Model Selector Guide

	BASE MODEL	BASE MODEL WITH FAN	OPEN FRAME	BATTERY BACKUP	BATTERY BACKUP AND FAN
12VDC Output					
40W				ICT22012-3APB *	
150W	ICT22012-12AP		ICT22012-12AO	ICT22012-12APB	
200W		ICT22012-18APF			ICT22012-18APFB
24VDC Output					
150W	ICT22024-6AP		ICT22024-6AO	ICT22024-6APB	
200W		ICT22024-8APF			ICT22024-8APFB

* This model is not CSA approved



Specifications

	Available Configurations					Input Voltage Range	Output Voltage	Output Current (Cont.)	Output Current (Peak)	Current Limiting	Line Regulation	Load Regulation	Output Ripple (Max)	Efficiency (Typical)	Operating Temp Range
	AP	AO	APB	APF	APFB										
ICT22012-3			●			105–250 VAC	13.8 VDC +/- 500mV	3.0 Amps	5.0 Amps	8.0 Amps	1.00%	2.00%	35mV RMS	84%	-10C to +52C
ICT22012-12	●	●	●			105–130/ 185–250 VAC	13.8 VDC +/- 100mV	10.0 Amps	12.0 Amps	13.0 Amps	0.10%	0.10%	25 mV RMS	80%	-10C to +52C
ICT22012-18				●	●	105–130/ 185–250 VAC	13.8 VDC +/- 100mV	15.0 Amps	17.0 Amps	18.0 Amps	0.10%	0.10%	25 mV RMS	80%	-10C to +52C
ICT22024-6	●	●	●			105–130/ 185–250 VAC	27.6 VDC +/- 100mV	6.0 Amps	6.5 Amps	7.0 Amps	0.10%	0.10%	25 mV RMS	80%	-10C to +52C
ICT22024-8				●	●	105–130/ 185–250 VAC	27.6 VDC +/- 100mV	8.0 Amps	8.5 Amps	9.0 Amps	0.10%	0.10%	25 mV RMS	80%	-10C to +52C

AP - Panel Mount
AO - Open Frame

APB - Panel Mount with Battery Back-Up
APF - Panel Mount with Fan

APFB - Panel Mount with Fan and Battery Backup

At ICT we specialize in custom designs and modifications. If you don't see exactly what you need contact us and let our engineering team design your custom power supply.

Dimensions

22012-3

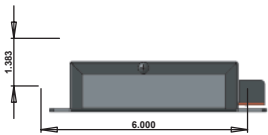
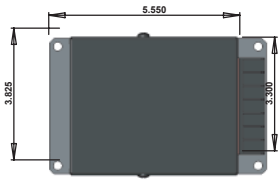

22012-12, 22012-18, 22024-6, 22024-8

